

SPRSUN DC inverter multi-function unit APP online OTA upgrade tutorial

一、Open APP“ Heat Pump” 。

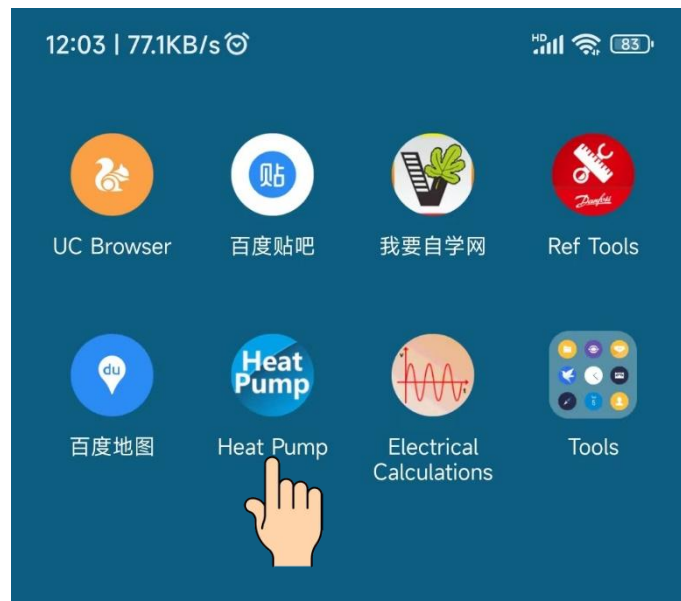

二、In the APP, click in the order shown in the figure below to enter the device main control program upgrade interface:

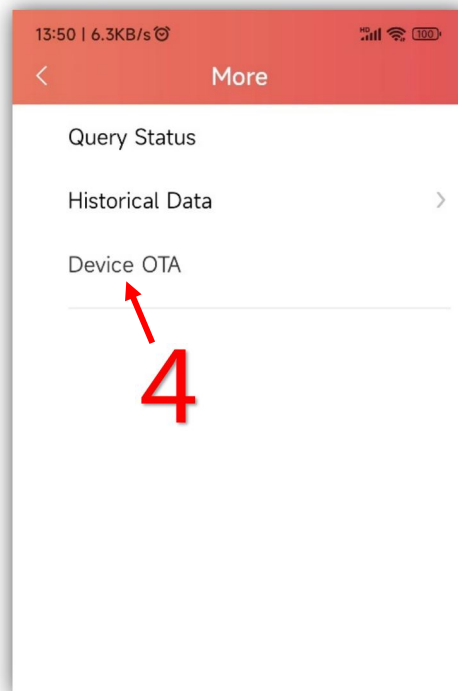
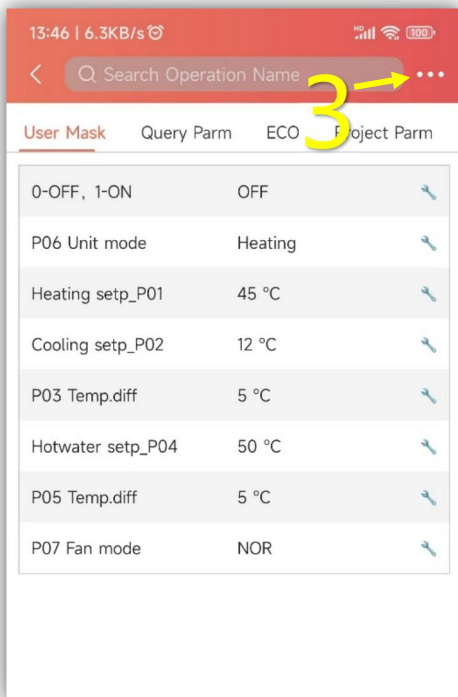
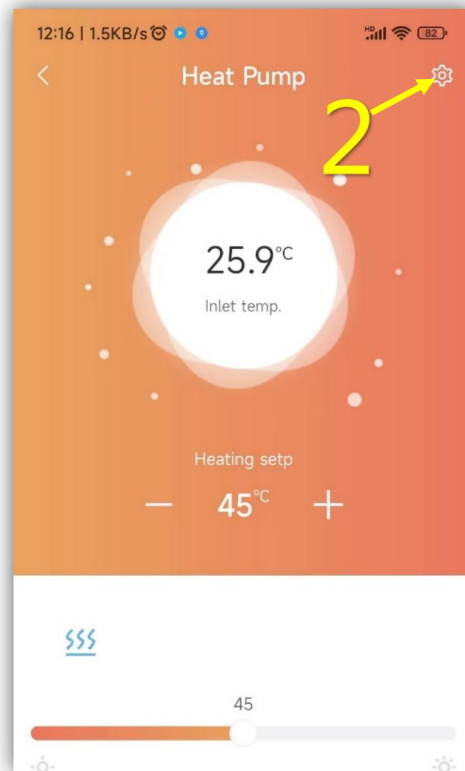
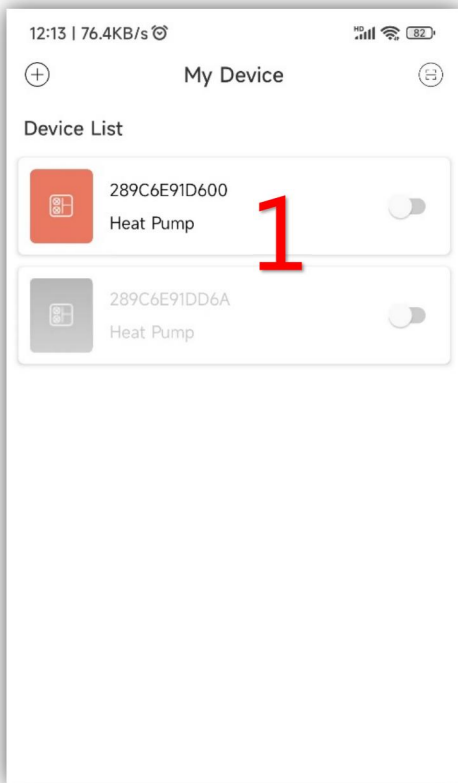

三、 After clicking step 4 above, a dialog will pop up asking if you want to upgrade, click OK to start the upgrade.

1、 Click the "OK" button

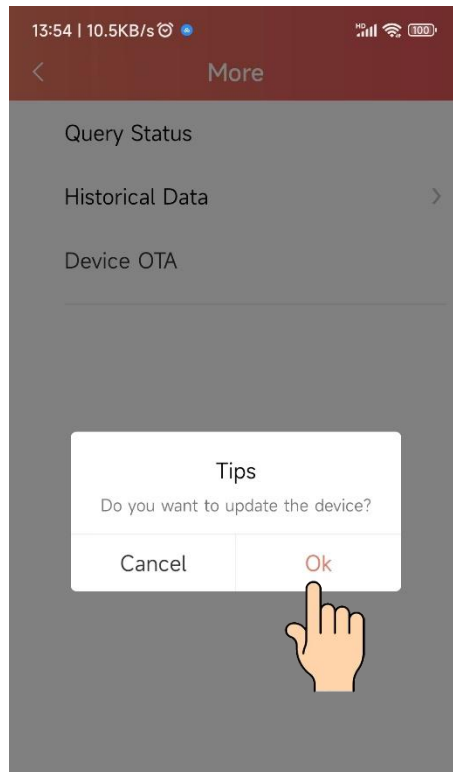

2 、 The upgrade starts automatically and displays the completion percentage and progress bar, as shown in the following figure:

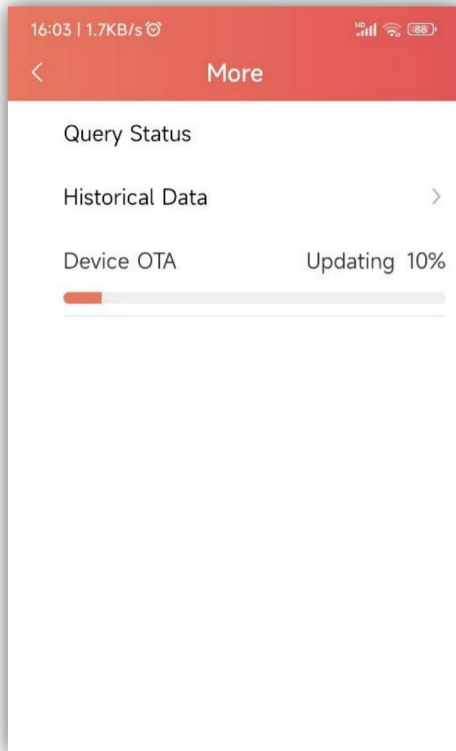

3、 When the progress displays "Update end, 100%", the upgrade is complete.

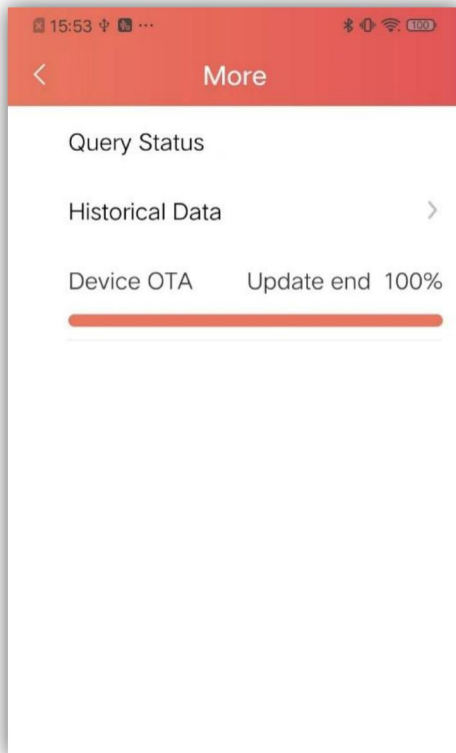

WIFI module connection

1、Accessories required for module connection

signal line

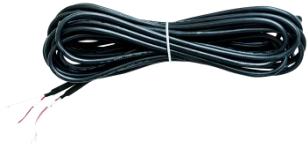

Power supply



connecting line



WIFI module



Connection

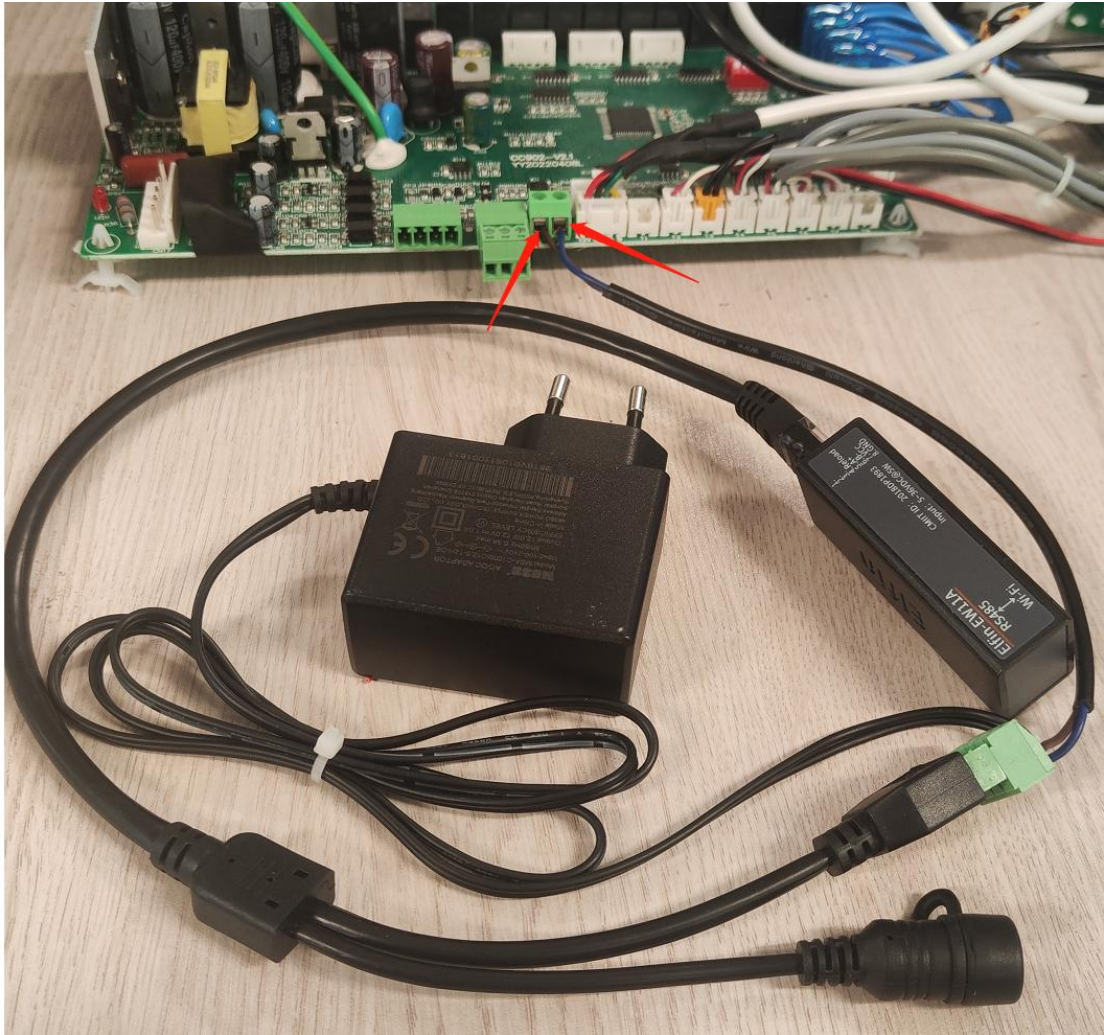

Note: When connecting the signal line, pay attention to the position of the red line and the white line. The red end is connected to the A of the connection line, and the other end is connected to the A of the main control board; the white end is connected to the B of the connection line, and the other end is connected to the B of the main control board. communication.

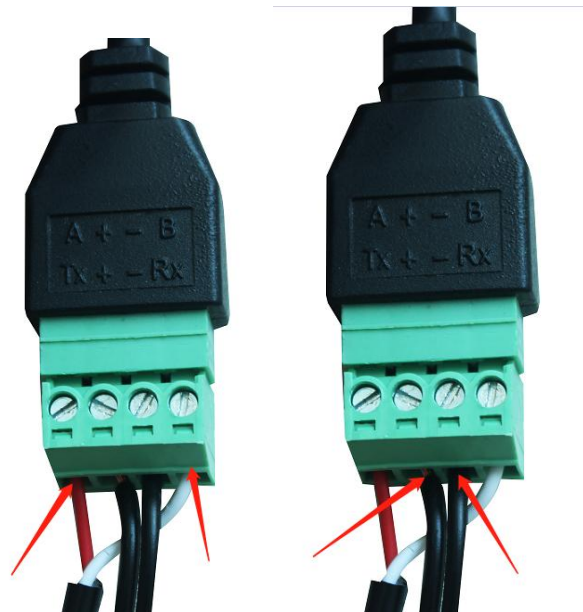
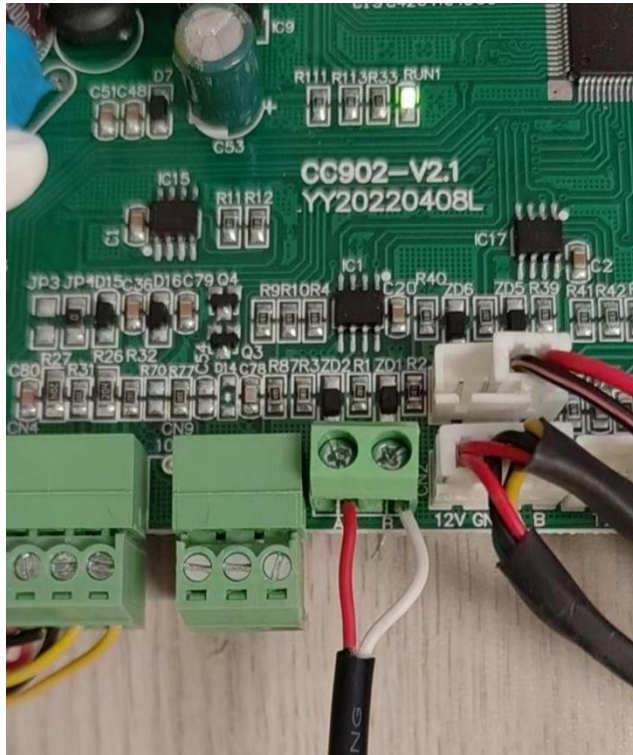

The power plug is connected to the 230V power supply. The black and white line of the power cable is connected to the + of the connecting line, and the black line is connected to the - of the connecting line. If the connection is reversed, the module cannot supply power.

APP add equipment:

1. When it is used for the first time, the WIFI module needs to be equipped with a network to use it. The network configuration steps are as follows:

Step 1: Register

After downloading the APP, enter the APP landing page. Click the new user to register with the mobile phone number or email. After successful registration, enter the user name and password and click to log in. (App download needs to scan the QR code below, and then choose to open in the browser to download)



QR code

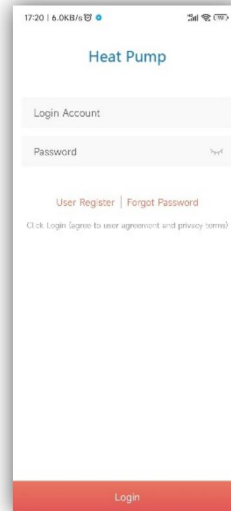

Registration interface

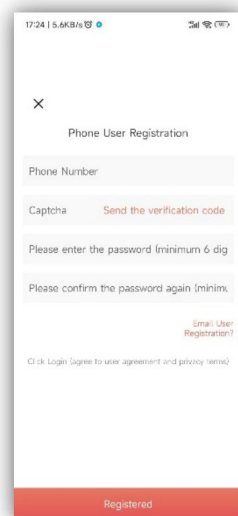

Mobile Registration

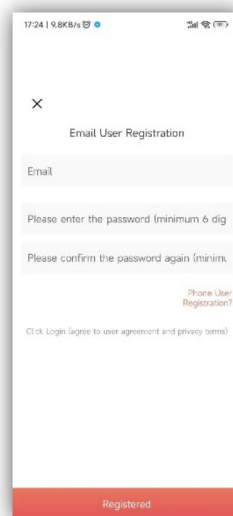

Email Registration

The second step:

1. Add devices on the LAN

Modules that have not been connected to the network require the LAN to add devices. After

entering my device, click the icon  in the upper left corner to enter the add device page, the above box will display the name of the WIFI currently connected to the phone, enter the WIFI password, first gently press the raised button of the connection line, and then click add device, Until it shows that the connection is successful, then click the arrow, you can see the currently connected APP is displayed in the list.



Click the button of the module, then its green light will flash to enter the distribution network mode.

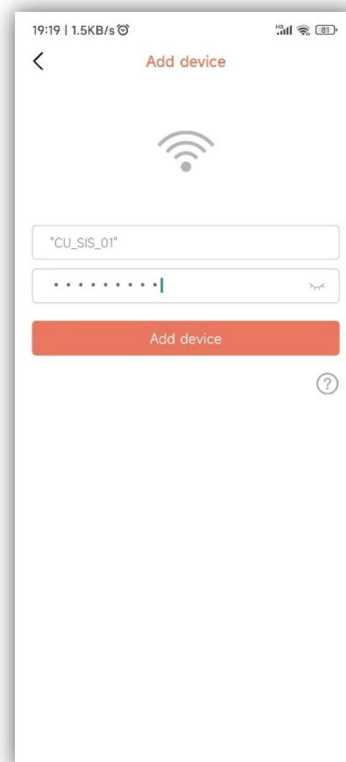

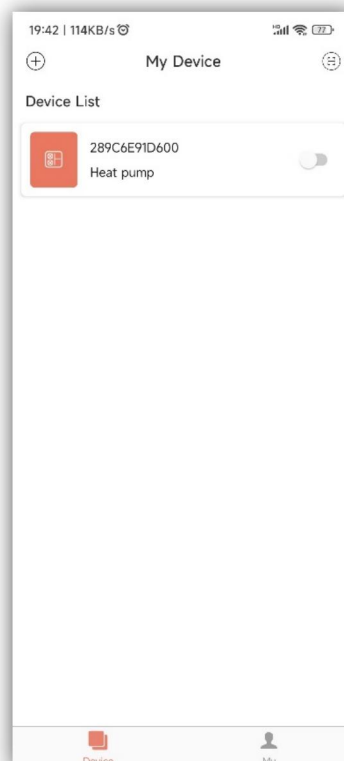
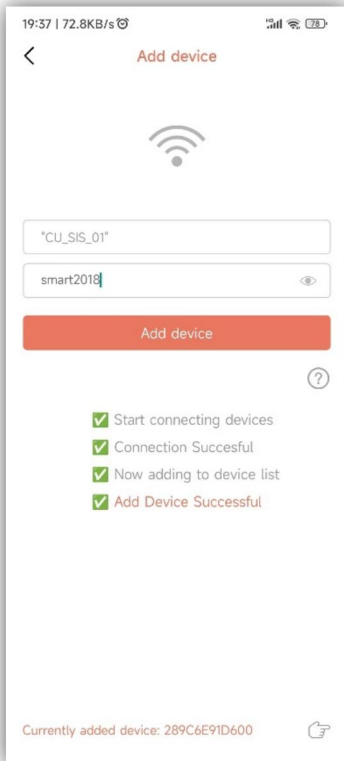
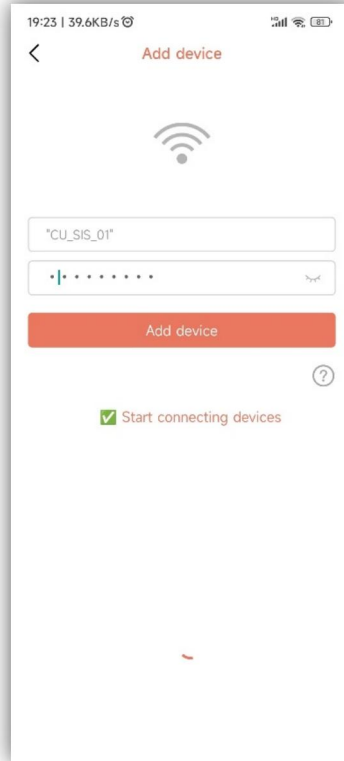
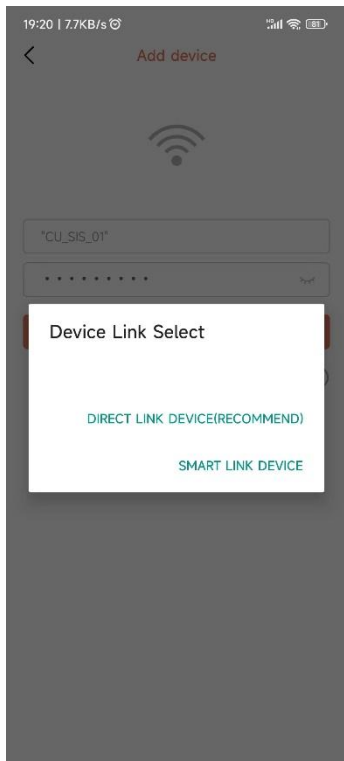

Scanning the QR code to add devices: For the modules which have binded APP, you can scan the QR code to add devices. If the module has been connected to the

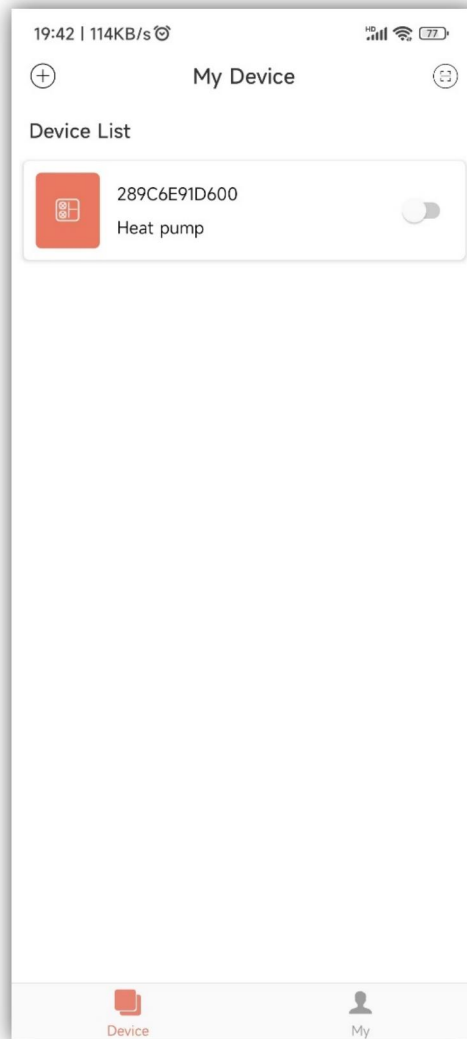

network, it will be automatically connected to the network after power-up. Moreover for modules binded APP previously, click the icon on the left side of the APP device list to display its QR code. If others want to binding this module, click the icon directly and then scan the QR code.

Explanation

- 1) The device list displays the device associated with this user, and shows the device's online and offline status. When the device is offline, the device icon is gray, and the device is online color.
- 2) The switch on the right side of each device row indicates whether the device is currently turned on.
- 3) The user can disassociate with the device or modify the device name. When swiping to the left, the delete and edit buttons appear on the right side of the device row. Click Edit to modify the device name, and click Delete to disassociate the device, as shown below:

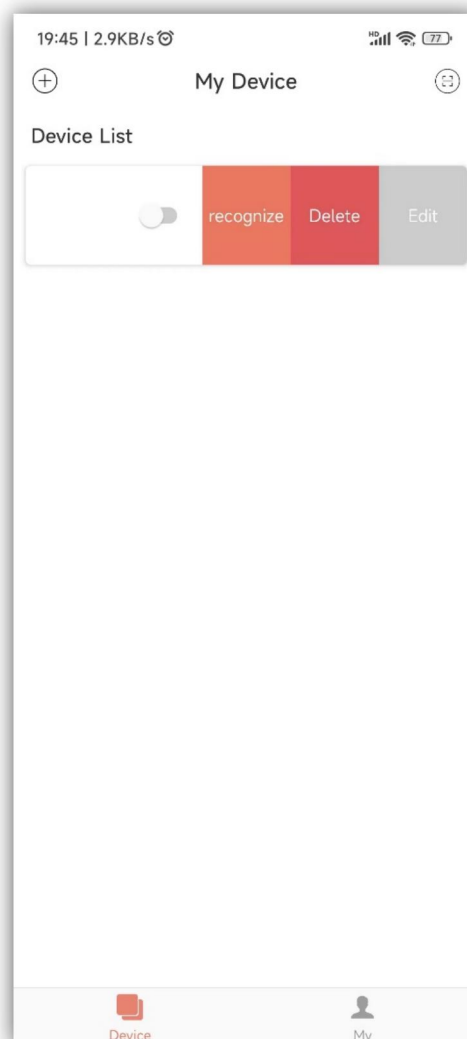

- 4) When adding a device to the local area network, the App will connect the device to the local area network through the local area network WiFi connected to the mobile phone. If you want to connect the device to the specified WiFi, please select the WiFi in the wireless LAN set in the mobile phone before returning to this page.

- 5) The App must follow the privacy and safe use of mobile phones, so before entering this page to add a device, the App will ask the user if they agree to access the user's location. If it is not allowed, the App will not be able to complete the LAN addition of the device.
- 6) 6) The WiFi icon on the page shows the name of the local area network WiFi connected to the mobile phone. In the input box under the WiFi name, the user needs to fill in the WiFi connection password. The user can click on the eye icon to confirm that the password is filled in correctly.
- 7) Short press the module's network distribution case, and confirm whether the device has entered the connectable state. The device's connection indicator flashes at a high speed to indicate that it has entered the network ready state), and then click the add device button, and the App will automatically add and Bind the device. Click the question mark icon in the lower right corner of the password input box, you can see detailed help instructions
- 8) The process of adding a device includes the connection and adding process of the device. The connection process refers to the device connecting to the local area network, and the addition process refers to adding the device to the user's device list. After the device is successfully added, the user can use the device. The process information for adding a device is as follows:
 - Start connecting devices.
 - The device connection succeeds or fails.
 - Start adding devices.
 - The device is successfully added or failed.

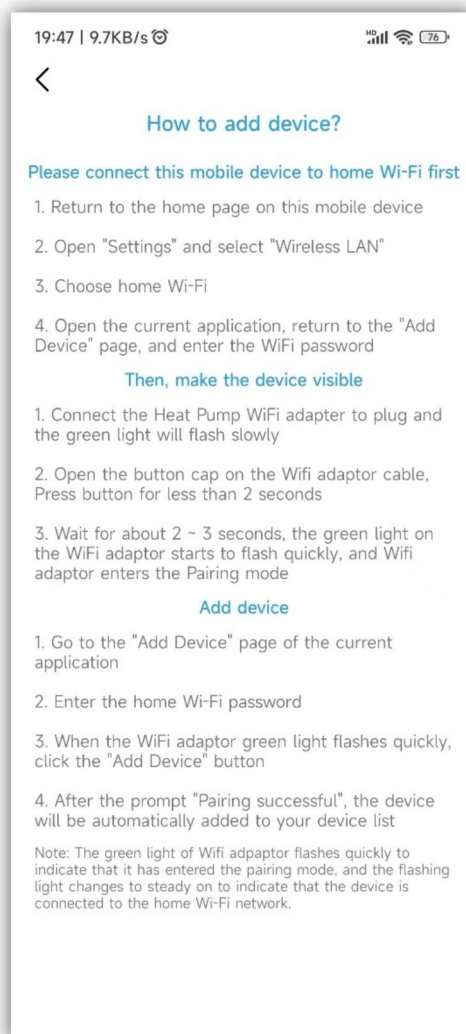

Use of APP

1.1. Device Homepage

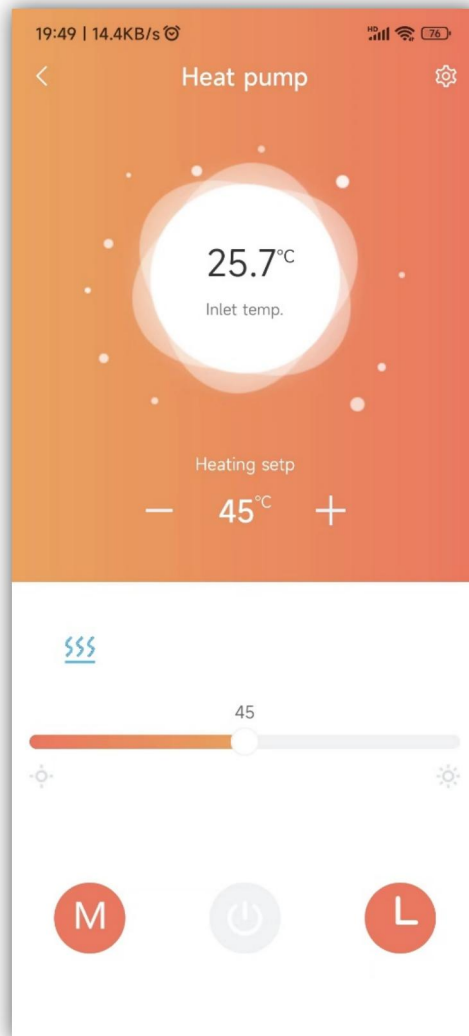

Explanation

- 1) Click a device in the device list to enter this page.
- 2) The background color of the bubble indicates the current operating state of the device:
 - a . Gray indicates that the device is in the shutdown state, at this time, you can change the working mode, set the mode temperature, set the timing, or you can press the key to switch on and off.
 - b . Multicolor indicates that the device is turned on, each working mode corresponds to a different color, orange indicates heating mode, red indicates hot water mode, and blue indicates cooling mode.

- C . When the device is in the power-on state, you can set the mode temperature, set the timer, press the key to switch on and off, but you can not set the working mode (that is, the working mode can only be set when the device is off)
- 3) The bubble shows the current temperature of the device.
 - 4) Below the bubble is the set temperature of the device in the current operating mode.

Click the +, – buttons on the left and right sides of the set temperature, and each time the current setting value is transmitted plus 1 or minus 1, it is set to the device.

Set the status category to fault alarm. When the device alarms, the alarm reason will be displayed next to the alarm icon. When a fault alarm occurs in the device, the area related to the fault alarm code will be displayed in green in this area. Click this area to jump to the detailed fault alarm page in the specific area, as shown in the following figure:

Setting	Freq Setting	Timer Setting	Error Info
Er14	Hotwater temp	NO	
Er21	Ambi temp	NO	
Er16	coil temp.	NO	
Er27	Outlet temp.	NO	
Er05	High pressure sensor failure	NO	
Er01	Phase sequence	NO	
Er03	Water flow failure	NO	
Er32	High protection of heating water outlet	NO	
Er18	Outlet gas temp. failure	NO	
Er15	Water inlet temp. failure	NO	
Er12	Exhaust temperature is too high	NO	
Er62	ECO in temperature sensor failure	NO	
Er63	ECO out temperature sensor failure	NO	
Er23	Low protection of cooling water outlet	NO	
Er28	Inlet gas temp.		

Immediately below the fault alarm area, the current working mode, heat pump, fan, and compressor ON status are displayed in sequence (there is a corresponding blue icon when it is turned on, and it is not displayed when it is turned off).

The slider at the bottom is used to set the temperature in the current mode. Slide the slider left and right to set the allowable temperature value in the current working mode.

There are three buttons at the bottom, from left to right: working mode, device power on and off, device timing.

Click the working mode to see the mode selection menu, you can set the working

mode of the device (black is the current setting mode of the device). As shown below:

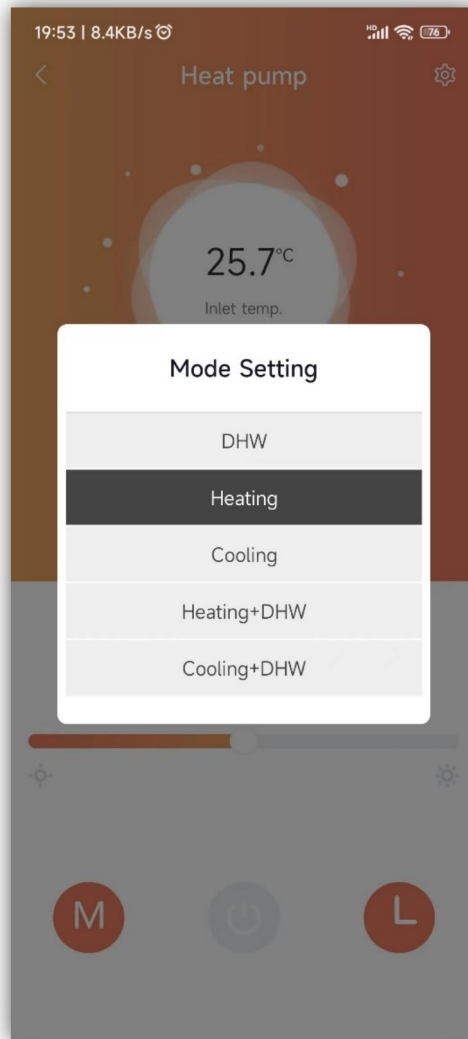

Click the device on/off, and set the on/off command to the device.

Click the device timing to see the timing setting menu, adjust the enable button on the right to the right, then the group timing is valid, and the current timing is invalid when it is on the left:

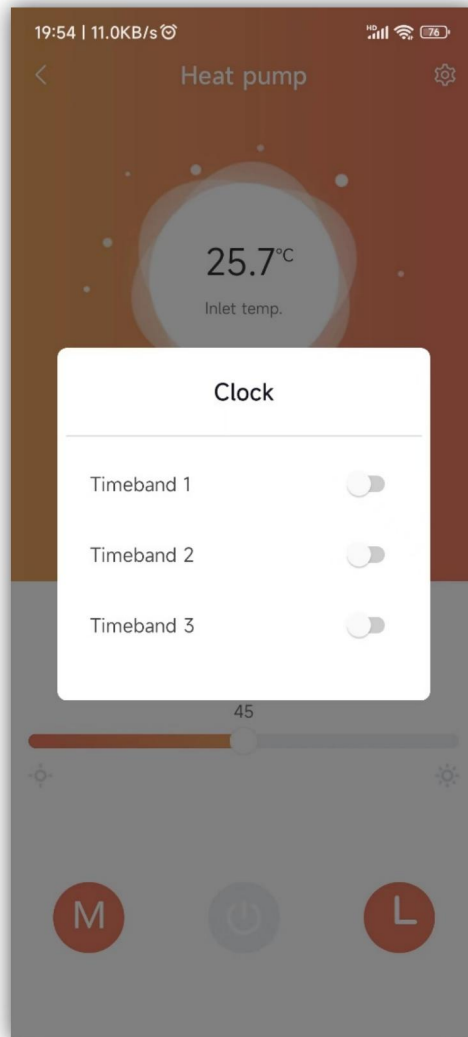

Device Details

Explanation:

Click the menu in the upper right corner of the device main page to enter this page.

Users with manufacturer privileges can see all the functions of the device, with the following labels:

User parameters, parameter query, economic mode, engineering parameters, main expansion valve settings, auxiliary expansion valve settings, defrost settings, fan

settings, other parameter reading, parameter settings, frequency settings, timing settings, faults.

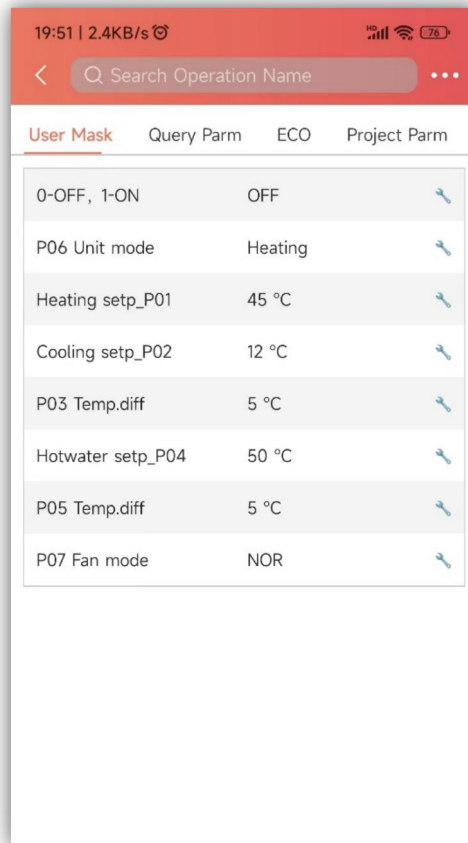

The screenshot shows a mobile application interface with a red header bar. The status bar at the top displays the time 19:51, data usage 2.4KB/s, and a battery level of 76%. Below the header is a search bar labeled 'Search Operation Name'. A navigation bar below the search bar contains four tabs: 'User Mask' (selected), 'Query Parm', 'ECO', and 'Project Parm'. The main content area displays a list of parameters in a table format, with each row containing a parameter name, its current value, and a blue wrench icon for editing.

Parameter Name	Value	Action
0-OFF, 1-ON	OFF	⚙️
P06 Unit mode	Heating	⚙️
Heating setp_P01	45 °C	⚙️
Cooling setp_P02	12 °C	⚙️
P03 Temp.diff	5 °C	⚙️
Hotwater setp_P04	50 °C	⚙️
P05 Temp.diff	5 °C	⚙️
P07 Fan mode	NOR	⚙️

Users with user rights can see some device functions:

User parameters, parameter query, economic mode, engineering parameters, faults.